

**NOTES:**

1.MATERIAL: Brass,T=0.20mm Pitch=5.59mm

2.PLATING:

XXu" Au over 50u" Nickel min on contact area

80u" Tin over 50u" Nickel on solder tail

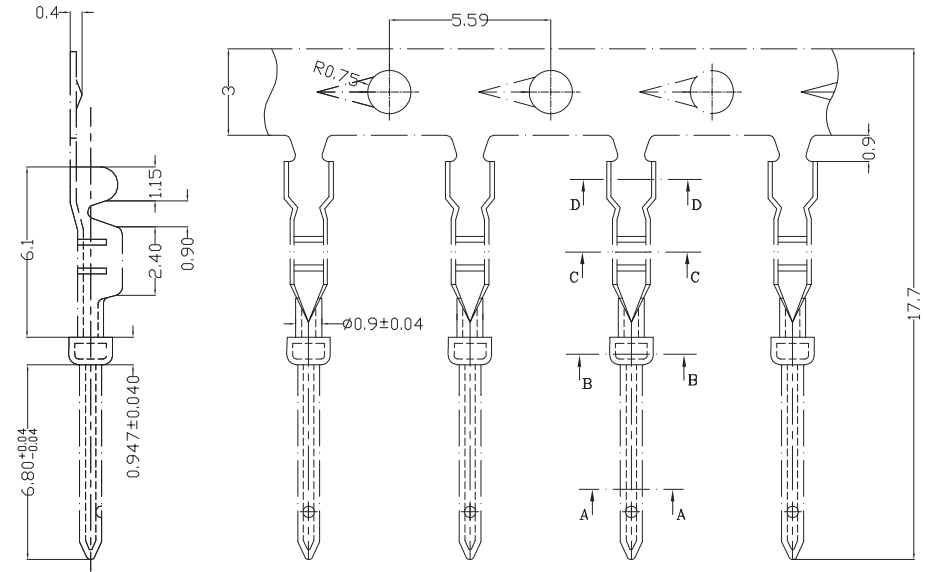
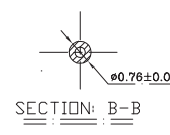
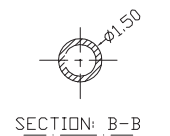
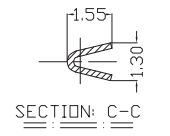
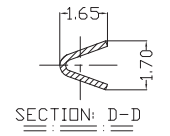

**NOTES:**

1.1.MATERIAL: Phosphor bronze,T=0.20mm Pitch=5.59mm

2.PLATING:

XXu" Au over 50u" Nickel min on contact area

80u" Tin over 50u" Nickel on solder tail

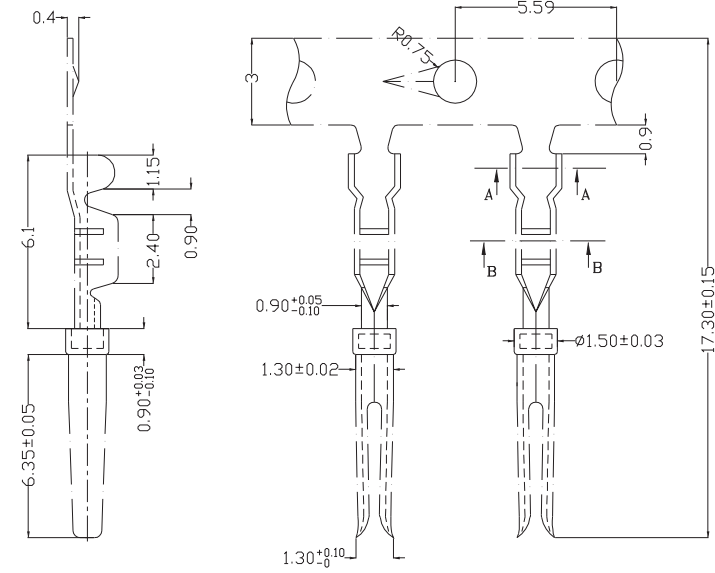
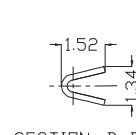
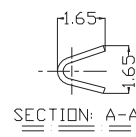

FAMILY	MODEL	TYPE	AWG
DH	C	M [male]	1M (AWG 26-24)
		F [female]	



**euro-conn**



UNITS: mm

SHEET SIZE: ISO A4

SCALE:---

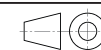

First angle projection

> 0 ~ 3

> 3 ~ 18

> 18 ~ 50

> 50 ~ 120

± 0.12

± 0.15

± 0.3

± 0.5

**DHCX**