

## Specifications

Poles: 2 to 12P/2X1 to 2X12P

Current rating: 5A AC, DC

Voltage rating: 250V AC, DC

Temperature range: -25°C to +85°C

Contact resistance:  $\leq 30\text{m}\Omega$

Insulation resistance:  $\geq 1000\text{M}\Omega$

Withstand voltage: 1500V AC/minute

Applicable wire: AWG #20 to #24

Applicable PC board thickness: 1.6mm to 2.0mm

Housing: PA66 (UL94V0) Black

Poll	A	B
2	-	3,85
4	3	6,85
6	6	9,85
8	9	12,85
10	12	15,85
12	15	18,85
14	18	21,85
16	21	24,85
18	24	27,85
20	27	30,85
22	30	33,85
24	33	36,85

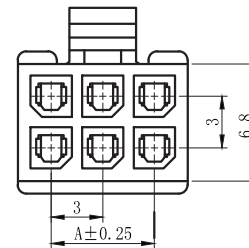

CKT SIZES 6-24

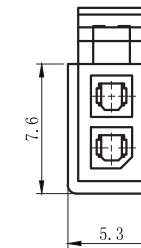

CKT SIZES 2

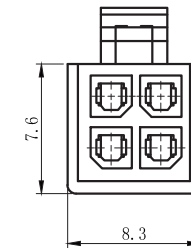

CKT SIZES 4

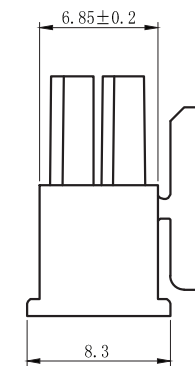
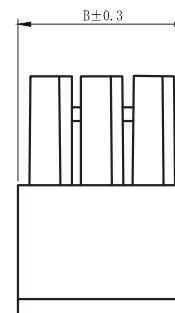

CKT SIZES 6-24

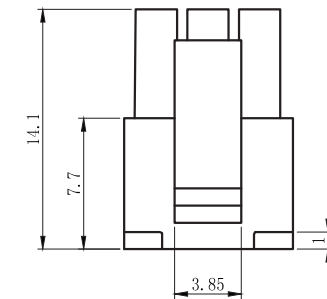

Come Ordinare

No Poli

**RM**MT - **2** **XX** **HZ**OV



**euro-conn**



UNITS: mm

SHEET SIZE: ISO A4

SCALE: 10:1

> 0 ~ 3

> 3 ~ 18

> 18 ~ 50

> 50 ~ 120

± 0.12

± 0.15

± 0.3

± 0.5



First angle projection

**MICRO-300**